

**NOTICE!!**

**These documents have been scanned!**

**Do not place un-scanned documents beneath this notice!**

**Do not remove this notice from this file!**

GPO Jacket No. 560-102  
Print Order 61540  
Rise Business Services, LLC  
Job=AZ15 7/11/2019



Box Number= AZ15155



Claim Begin-End: AMC452323-AMC452330

**1 Initial Receipt**



AZ15155-32

AMC452349-AMC452348

**United States Department of the Interior**  
**Bureau of Land Management**  
 DIV OF LANDS, MINRLS & ENERGY  
 ONE N CENTRAL AVE  
 PHOENIX, AZ 85004 -4427  
 Phone: 602-417-9200

Receipt

No: 4284005

<b>Transaction #:</b> 4399983	
<b>Date of Transaction:</b> 10/15/2018	
<b>CUSTOMER:</b>	
TONY BROWN 33114 N BRINLEE LN SAN TAN VALLEY, AZ 85143-6401 US	

LINE #	QTY	DESCRIPTION	REMARKS	UNIT PRICE	TOTAL
1	8.00	LOCATABLE MINERALS / MINING CLAIMS-NEW, UNADJUD, ONE OR MORE AUTH NOS / NEW MINING CLAIM PROCESSING FEE <b>CASES:</b> AMC452323/\$20.00, AMC452324/\$20.00, AMC452325/\$20.00, AMC452326/\$20.00, AMC452327/\$20.00, AMC452328/\$20.00, AMC452329/\$20.00, AMC452330/\$20.00		- n/a -	160.00
2	8.00	LOCATABLE MINERALS / MINING CLAIMS-NEW, UNADJUD, ONE OR MORE AUTH NOS / NEW MINING CLAIMS LOCATION FEE <b>CASES:</b> AMC452323/\$37.00, AMC452324/\$37.00, AMC452325/\$37.00, AMC452326/\$37.00, AMC452327/\$37.00, AMC452328/\$37.00, AMC452329/\$37.00, AMC452330/\$37.00		- n/a -	296.00
3	8.00	LOCATABLE MINERALS / MINING CLAIMS-NEW, UNADJUD, ONE OR MORE AUTH NOS / NEW MINING CLAIMS MAINTENANCE FEE <b>CASES:</b> AMC452323/\$155.00, AMC452324/\$155.00, AMC452325/\$155.00, AMC452326/\$155.00, AMC452327/\$155.00, AMC452328/\$155.00, AMC452329/\$155.00, AMC452330/\$155.00		- n/a -	1240.00
<b>TOTAL:</b>					<b>\$1,696.00</b>

PAYMENT INFORMATION			
1	AMOUNT:	1696.00	POSTMARKED: N/A
	TYPE:	CHECK	RECEIVED: 10/15/2018

CHECK NO:	1556
NAME:	AMERICAN MINING RIGHTS ASSOC 6386 GREELEY HILL RD PMB 607 COULTERVILLE CA 95311 US

REMARKS

This receipt was generated by the automated BLM Collections and Billing System and is a paper representation of a portion of the official electronic record contained therein.



**NOTICE!!**

**These documents have been scanned!**

**Do not place un-scanned documents beneath this notice!**

**Do not remove this notice from this file!**

GPO Jacket No. 560-102  
Print Order 61540  
Rise Business Services, LLC  
Job=AZ15 7/11/2019



Box Number= AZ15155



Claim Begin-End: AMC452323-AMC452330

**2 Correspondence**



AZ15155-32

AMC452349-AMC452348



**NO  
DOCUMENTS  
FOUND**

NO DOCUMENTS FOUND  
NO DOCUMENTS FOUND

**NOTICE!!**

**These documents have been scanned!**

**Do not place un-scanned documents beneath this notice!**

**Do not remove this notice from this file!**

GPO Jacket No. 560-102  
Print Order 61540  
Rise Business Services, LLC  
Job=AZ15 7/11/2019



Box Number= AZ15155



Claim Begin-End: AMC452323-AMC452330

**3 Transfers**



AZ15155-32

AMC452349-AMC452348



**NO  
DOCUMENTS  
FOUND**

NO DOCUMENTS FOUND  
NO DOCUMENTS FOUND

**NOTICE!!**

**These documents have been scanned!**

**Do not place un-scanned documents beneath this notice!**

**Do not remove this notice from this file!**

GPO Jacket No. 560-102  
Print Order 61540  
Rise Business Services, LLC  
Job=AZ15 7/11/2019



Box Number= AZ15155



Claim Begin-End: AMC452323-AMC452330

**4 Annual Filings**



AZ15155-32

AMC452349-AMC452348



UNITED STATES  
DEPARTMENT OF THE INTERIOR  
BUREAU OF LAND MANAGEMENT  
**MAINTENANCE FEE WAIVER CERTIFICATION**

475  
*[Handwritten initials]*

452323

FORM APPROVED  
OMB NO. 1004-0114  
Expires:

SEE INSTRUCTIONS ON PAGE 2

- This small miner waiver is filed for the assessment year beginning on September 1, 2019 and ending on September 1, 2020.
- The undersigned and all related parties owned ten or fewer mining claims, mill, or tunnel sites located and maintained on Federal lands in the United States of America on September 1, 2019.
- The undersigned have performed the assessment work required by law for each mining claim listed prior to filing this waiver and understand that by filing this form, the undersigned must file an affidavit of assessment work with the Bureau of Land Management (BLM) by the December 30th following the filing of this waiver.
- The undersigned understand that if the assessment work obligation has not yet come due under 30 U.S.C. 28 (for those claims in their first assessment year only), a notice of intent to hold reciting this condition must be recorded by the December 30th following the filing of this waiver.
- The undersigned understand that mill and tunnel sites may also be listed on this waiver and be waived from payment of the maintenance fee, and that a notice of intent to hold for these sites is required to be filed with the BLM by the December 30th following the filing of this waiver.
- The undersigned understand and acknowledge that pursuant to 43 U.S.C. 1212 and 18 U.S.C. 1001, the filing or recording of a false, fictitious, or fraudulent document with the BLM may result in a fine of up to \$250,000, a prison term not to exceed five years, or both.
- The mining claims, mill or tunnel sites for which this waiver from payment of the maintenance fees is requested are:

CLAIM OR SITE NAME	BLM RECORDATION SERIAL NUMBER
1. COFFEE HOUR ✓	AMC452323
2. DEPLORABLE 1	AMC452324
3. DEPLORABLE 2	AMC452325
4. IRON LOCK 4	AMC452330
5.	
6.	
7.	
8.	
9.	
10.	

RECEIVED  
BLM AT STATE OFFICE  
2019 SEP - 3 P 2:32  
PHOENIX, ARIZONA

The owner(s) (claimants) of the above mining claims and sites are:

TONY BROWN

*T Brown*

(Owner's Name - Please Print)  
33114 N. BRINLEE LANE  
(Owner's Mailing Address)

(Owner's Signature)  
SAN TAN VALLEY AZ 85143  
(City) (State) (Zip Code)

(Owner's Name - Please Print)  
  
(Owner's Mailing Address)

(Owner's Signature)  
  
(City) (State) (Zip Code)

(Owner's Name - Please Print)  
  
(Owner's Mailing Address)

(Owner's Signature)  
  
(City) (State) (Zip Code)

(Owner's Name - Please Print)  
  
(Owner's Mailing Address)

(Owner's Signature)  
  
(City) (State) (Zip Code)

(Continued on page 2)

ENTERED  
SEP 17 2019  
BY: *[Signature]*

*[Handwritten initials]*

**NOTICE!!**

**These documents have been scanned!**

**Do not place un-scanned documents beneath this notice!**

**Do not remove this notice from this file!**

GPO Jacket No. 560-102  
Print Order 61540  
Rise Business Services, LLC  
Job=AZ15 7/11/2019



Box Number= AZ15155



Claim Begin-End: AMC452323-AMC452330

**5 Miscellaneous**



AZ15155-32

AMC452349-AMC452348



**NO  
DOCUMENTS  
FOUND**

NO DOCUMENTS FOUND  
NO DOCUMENTS FOUND

**NOTICE!!**

**These documents have been scanned!**

**Do not place un-scanned documents beneath this notice!**

**Do not remove this notice from this file!**

GPO Jacket No. 560-102  
Print Order 61540  
Rise Business Services, LLC  
Job=AZ15 7/11/2019



Box Number= AZ15155



Claim Begin-End: AMC452323-AMC452330

**6 Location Notices-Amendments and Supporting Documents**

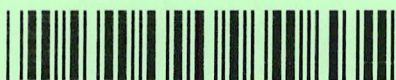

AZ15155-32

AMC452349-AMC452348

# MINING CLAIM STATUS REPORT

Data Entered: 10/19/2017

MTP Checked By: MLL

GEO Checked By: NO REPORTS

LEAD SERIAL NUMBER:

AMC 452323

thru

AMC 452330

NUMBER OF CLAIMS & TYPE:

8 LODE  
     PLACER  
     ASSOCIATION PLACER  
     MILL SITE  
     TUNNEL SITE

CHARGES:

Processing Fee @ \$20 = \$ 160  
 Location Fee @ \$37 = \$ 296  
 Maintenance Fee @ \$155 = \$ 1,240  
 Add'l Maint Fee for Assoc Placer = \$       
**SUBTOTAL** \$       
 Other Fees \$       
 Other Fees \$       
**TOTAL** \$ 1,696

TOTAL ACREAGE:

(Placer Only)

20 Per Claim

NUMBER OF LOCATORS: 1

DOCUMENTS RECEIVED VIA:

Over-the-Counter [ ]

Mail [ ]

TIMELY FILED:

Yes [ ] No [ ]

LEGAL DESCRIPTION:

T 12.5N R 3W SEC  
 T 8N R 3W SEC  
 T 7N R 3W SEC  
 T 12.5N R 2W SEC  
 T      R      SEC

25, 36  
34  
3  
30

BLM  FOREST SERVICE

Prescott

SUBJ TO PL 359: Yes [ ] No [ ]

WILDERNESS AREA [ ]

SPLIT ESTATE:

N/A [ ] SX [ ] PX [ ] OTHER [ ]

SRHA [ ] Was proper Notice filed if located on SHRA Land? Yes [ ] No [ ]

RECONVEYED MINERALS ON BLM LAND REQUIRE OPENING ORDER FROM 1944 TO 1993:

Open to Entry On \_\_\_\_\_ N/A [ ]

COMMENTS/STATUS:

VOID [ ] PARTIALLY VOID [ ] PVT MINERALS [ ] WITHDRAWN LANDS [ ]

OTHER [ ]

AMC 452323

[ ] Claimant acknowledges that portions of the following claim(s) site(s) may be void or voidable.

Printed Name of Claimant \_\_\_\_\_

Signature of Claimant \_\_\_\_\_

\*\*\*\*\*FINAL ADJUDICATION\*\*\*\*\*

DATE \_\_\_\_\_

INITIALS \_\_\_\_\_



**LOCATION NOTICE FOR PLACER MINING CLAIM**

Amendment BLM Serial # \_\_\_\_\_

NOTICE IS HEREBY GIVEN that the Coffee Hour

\_\_\_\_\_ placer mining claim has been located by

TONY BROWN whose current mailing

address is 33114 N. BRINLEE LANE, SAN TAN VALLEY, AZ 85143

BLM  
Date  
Stamp

RECEIVED  
BLM AZ STATE OFFICE  
2018 OCT 15 P 12:15  
PHOENIX, ARIZONA

The general course of this claim is North-South and it is situated in Yavapai

County, Arizona. This claim is 1320 feet in length and 660 feet in width.

20 Total Claim Acreage. This claim runs from the location monument on which this location notice is

posted at the SW corner of the claim approximately 660 feet in a East direction to the

East end line and 1320 feet in a North direction to the North end line. This claim is

marked by four monuments, one at each corner of the claim.

The location monument on which this notice is posted is situated within Section 36, Township

12.5N, Range 3W, Gila Salt River Base and Meridian, Arizona. This claim encompasses

portions of the following legal subdivision(s) if located by legal subdivision or the following quarter section(s),

section(s), Township(s) and Range(s) E 1/2 of SE 1/4 of SW 1/4 of Section 36, TWP 12.5N R3W

\_\_\_\_\_, Gila Salt River Base and Meridian, Arizona.

The locality of this claim with reference to some natural object or permanent monument and additional information

(if any) concerning its locality are as follows: \_\_\_\_\_

\_\_\_\_\_ The above information is shown on the attached map.

DATED AND POSTED on the ground this 12 day of October, 2018.

LOCATOR(s)  AGENT

Print Name(s) Tony Brown

Signature(s) Tony Brown

Form MCF102  
Revised July 2014

AN0452323

**MINING CLAIM MAP**

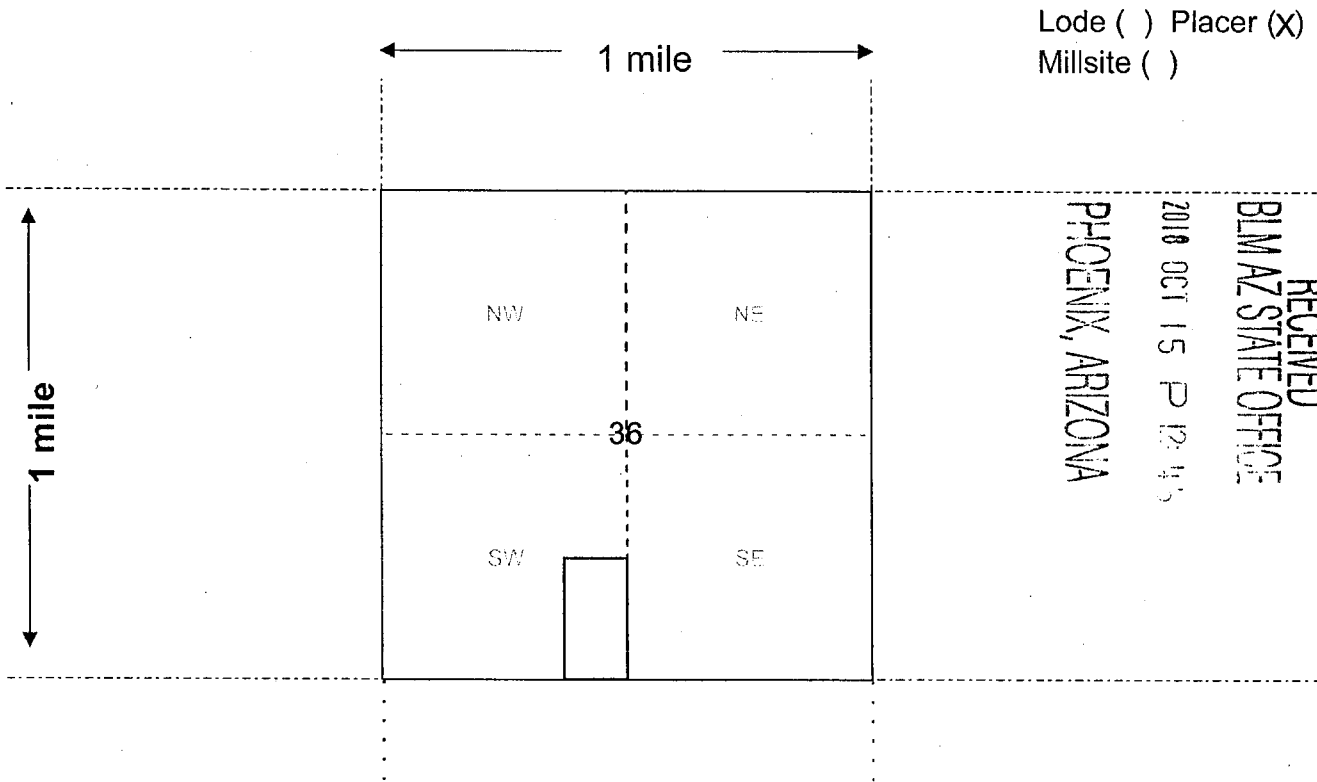

Lode ( ) Placer (X)  
 Millsite ( )

RECEIVED  
 BLM AZ STATE OFFICE  
 2018 OCT 15 P 12:45  
 PHOENIX, ARIZONA

- Scale: 1" = 2000 feet
- The above map depicts the Coffee Hour mining claim, which is located in Section (s) 36, Township 12.5 N, Range 3 W, Gila and Salt River Base and Meridian, Yavapai County, Arizona. Total claim acreage is 20
  - The type of corner and location monuments used are as follows: Steel post and plastic pipe  
Intersection of South end line of S36 T12.5N R3W and Hassayampa River
  - The bearings and distances in degrees and feet between claim corners and to a public land survey monument are as depicted on the map.
  - If the claim is a placer or millsite claim with exterior limits conforming to legal subdivisions of the public survey, provide a legal description of the claim E 1/2 of SE 1/4 of SW 1/4 of S36 T12.5N R3W

AN0452323

Form MCF100a  
 Revised July 2014

**LOCATION NOTICE FOR PLACER MINING CLAIM**

Amendment BLM Serial # \_\_\_\_\_

NOTICE IS HEREBY GIVEN that the Deplorable 1  
\_\_\_\_\_ placer mining claim has been located by  
Tony Brown whose current mailing  
address is 33114 N. BRINLEE LANE, SAN TAN VALLEY, AZ 85143

RECEIVED  
BLM AZ STATE OFFICE  
2018 OCT 15 P 12:44  
PHOENIX, ARIZONA  
BLM  
Date  
Stamp

The general course of this claim is SOUTH and it is situated in Yavapai

County, Arizona. This claim is 1320 feet in length and 660 feet in width.

20 Total Claim Acreage. This claim runs from the location monument on which this location notice is posted at the SW corner of the claim approximately 660 feet in a East direction to the East end line and 1320 feet in a North direction to the North end line. This claim is marked by four monuments, one at each corner of the claim.

The location monument on which this notice is posted is situated within Section 34, Township 8 N, Range 3 W, Gila Salt River Base and Meridian, Arizona. This claim encompasses portions of the following legal subdivision(s) if located by legal subdivision or the following quarter section(s), section(s), Township(s) and Range(s) E1/2 of the SW1/4 of the SE1/4 of Section 34, Township 8N, Range 3W, Gila Salt River Base and Meridian, Arizona.

The locality of this claim with reference to some natural object or permanent monument and additional information (if any) concerning its locality are as follows: \_\_\_\_\_

\_\_\_\_\_ The above information is shown on the attached map.

DATED AND POSTED on the ground this 11 day of October, 2018.

LOCATOR(s)  AGENT

Print Name(s) Tony Brown

Signature(s) *Tony Brown*

AR 045232



**MINING CLAIM MAP**

Lode ( ) Placer (X)  
Millsite ( )

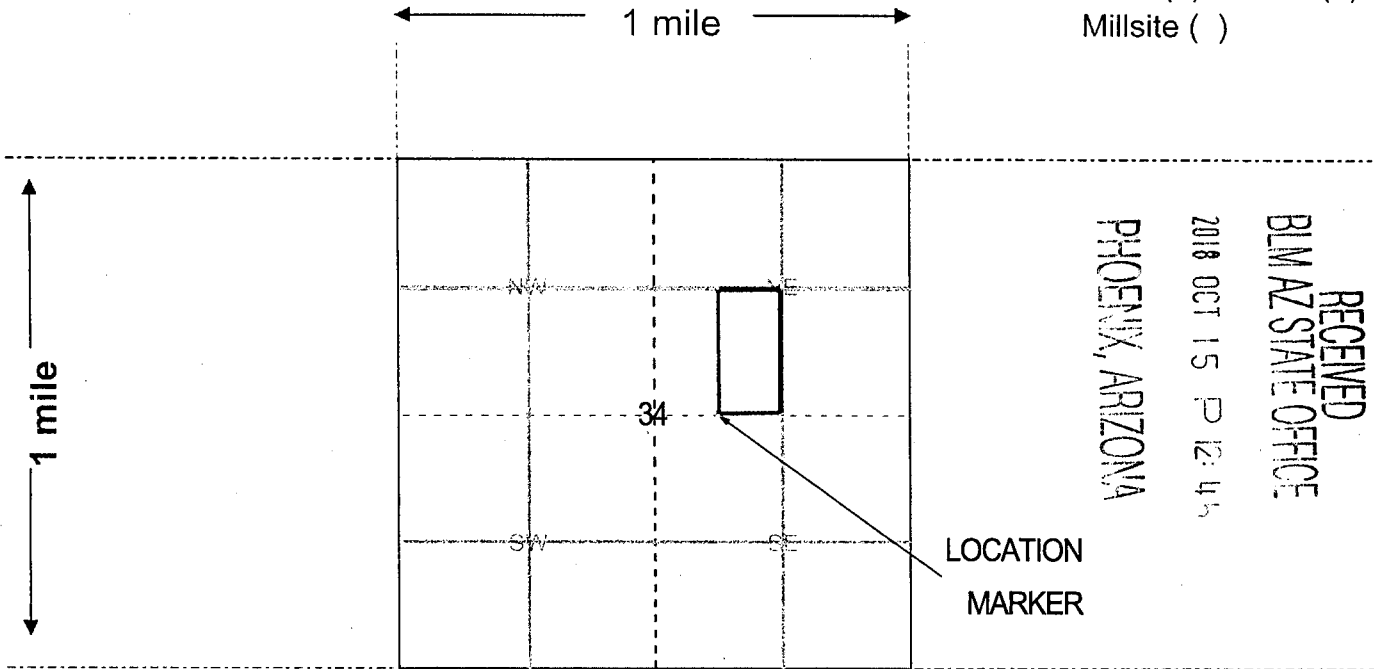

Scale: 1" = 2000 feet

1. The above map depicts the Deplorable 1 mining claim, which is located in Section (s) 34, Township 8 N, Range 3 W, Gila and Salt River Base and Meridian, Yavapai County, Arizona. Total claim acreage is 20

2. The type of corner and location monuments used are as follows: Capped, white pvc.

3. The bearings and distances in degrees and feet between claim corners and to a public land survey monument are as depicted on the map.

4. If the claim is a placer or millsite claim with exterior limits conforming to legal subdivisions of the public survey, provide a legal description of the claim E1/2 of the SW1/4 of the SE1/4 of Section 34, Township 8N, Range 3W

Form MCF100a  
Revised July 2014

This form is available from the **Arizona Geology Survey** and may be reproduced.

AMC452324

**LOCATION NOTICE FOR PLACER MINING CLAIM**

Amendment BLM Serial # \_\_\_\_\_

NOTICE IS HEREBY GIVEN that the Deplorable 2  
\_\_\_\_\_ placer mining claim has been located by  
Tony Brown whose current mailing  
address is 33114 N. BRINLEE LANE, SAN TAN VALLEY, AZ 85143

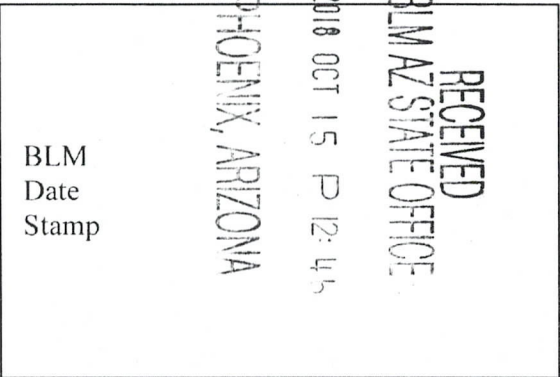

The general course of this claim is East and it is situated in Yavapai

County, Arizona. This claim is 660 feet in length and 1320 feet in width.

20 Total Claim Acreage. This claim runs from the location monument on which this location notice is posted at the SW corner of the claim approximately 1320 feet in a East direction to the East end line and 660 feet in a North direction to the North end line. This claim is marked by four monuments, one at each corner of the claim.

The location monument on which this notice is posted is situated within Section 34, Township 8 N, Range 3 W, Gila Salt River Base and Meridian, Arizona. This claim encompasses portions of the following legal subdivision(s) if located by legal subdivision or the following quarter section(s), section(s), Township(s) and Range(s) N1/2 of the NW1/4 of the SE1/4 of Section 34, Township 8N, Range 3W, Gila Salt River Base and Meridian, Arizona.

The locality of this claim with reference to some natural object or permanent monument and additional information (if any) concerning its locality are as follows: \_\_\_\_\_

\_\_\_\_\_ The above information is shown on the attached map.

DATED AND POSTED on the ground this 11 day of October, 2018.

LOCATOR(s)  AGENT

Print Name(s) Tony Brown

Signature(s) Tony Brown

AMC 15235

**MINING CLAIM MAP**

Lode ( ) Placer (X)  
Millsite ( )

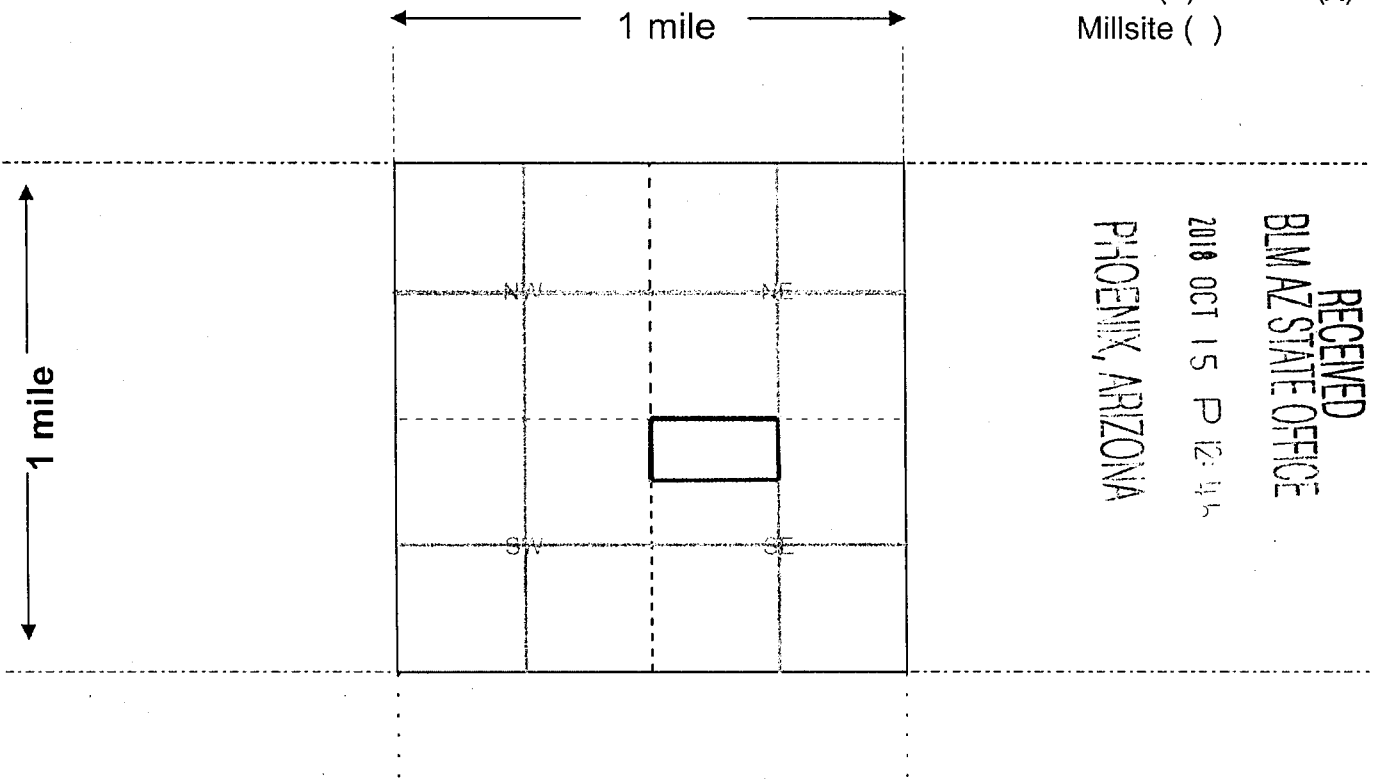

RECEIVED  
BLM AZ STATE OFFICE  
2010 OCT 15 P 12:45  
PHOENIX, ARIZONA

Scale: 1" = 2000 feet



1. The above map depicts the Deplorable 2 mining claim, which is located in Section (s) 34, Township 8 N, Range 3 W, Gila and Salt River Base and Meridian, Yavapai County, Arizona. Total claim acreage is 20

2. The type of corner and location monuments used are as follows: Capped, white pvc.

3. The bearings and distances in degrees and feet between claim corners and to a public land survey monument are as depicted on the map.

4. If the claim is a placer or millsite claim with exterior limits conforming to legal subdivisions of the public survey, provide a legal description of the claim N1/2 of the NW1/4 of the SE1/4 of Section 34, Township 8N, Range 3W

Form MCF100a  
Revised July 2014

This form is available from the **Arizona Geology Survey** and may be reproduced.

AMC 452325



**LOCATION NOTICE FOR PLACER MINING CLAIM**

Amendment BLM Serial # \_\_\_\_\_

NOTICE IS HEREBY GIVEN that the Glow Wash 1  
\_\_\_\_\_ placer mining claim has been located by  
JAMES HAMILTON whose current mailing  
address is 34424 N. TOMBSTONE ST.  
SAN TAN VALLEY, AZ 85140

RECEIVED  
BLM AZ STATE OFFICE  
2018 OCT 15 P 12:14h  
PHOENIX, ARIZONA  
BLM  
Date  
Stamp

The general course of this claim is East to West and it is situated in Yavapai  
County, Arizona. This claim is 660 feet in length and 1320 feet in width.

20 Total Claim Acreage. This claim runs from the location monument on which this location notice is  
posted at the NW corner of the claim approximately 660 feet in a West direction to the  
West end line and 660 feet in a South direction to the South end line. This claim is  
marked by four monuments, one at each corner of the claim.

The location monument on which this notice is posted is situated within Section 3, Township  
7 N, Range 3 W, Gila Salt River Base and Meridian, Arizona. This claim encompasses  
portions of the following legal subdivision(s) if located by legal subdivision or the following quarter section(s),  
section(s), Township(s) and Range(s) N1/2 OF SE1/4 OF SE 1/4 OF SECTION 3, TWP 7N, RANGE 3W  
\_\_\_\_\_, Gila Salt River Base and Meridian, Arizona.

The locality of this claim with reference to some natural object or permanent monument and additional information  
(if any) concerning its locality are as follows: \_\_\_\_\_

\_\_\_\_\_ The above information is shown on the attached map.

DATED AND POSTED on the ground this 11 day of October, 2018.

LOCATOR(s)  AGENT

Print Name(s) JAMES HAMILTON

Signature(s) 

Form MCF102  
Revised July 2014

AMC 452326

**MINING CLAIM MAP**

Lode ( ) Placer (X)  
 Millsite ( )

RECEIVED  
 BLM AZ STATE OFFICE  
 2018 OCT 15 P 12:11  
 PHOENIX, ARIZONA

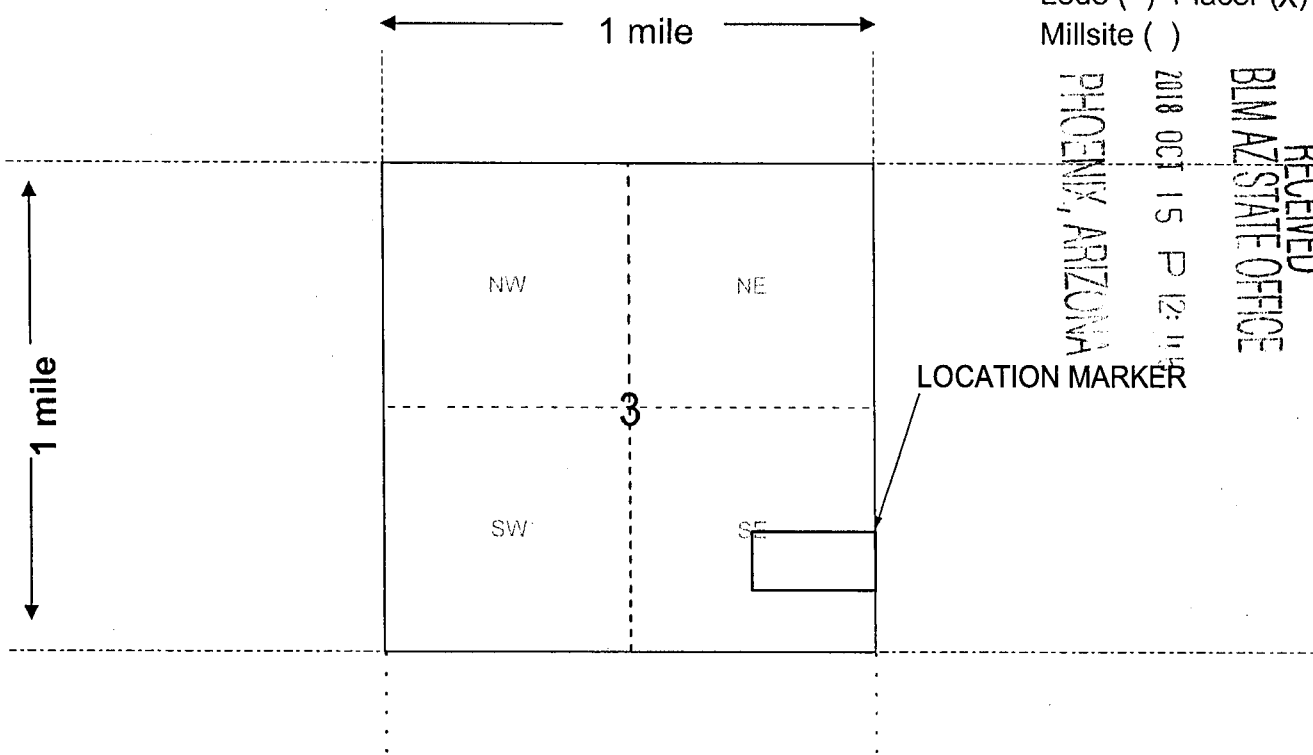

LOCATION MARKER

Scale: 1" = 2000 feet



1. The above map depicts the GLOW WASH 1 mining claim, which is located in Section (s) 3, Township 7 N, Range 3 W, Gila and Salt River Base and Meridian, YAVAPAI County, Arizona. Total claim acreage is 20

2. The type of corner and location monuments used are as follows: WHITE, CAPPED PVC PIPE

3. The bearings and distances in degrees and feet between claim corners and to a public land survey monument are as depicted on the map.

4. If the claim is a placer or millsite claim with exterior limits conforming to legal subdivisions of the public survey, provide a legal description of the claim N1/2 OF SE1/4 OF SE 1/4 OF SECTION 3,  
TOWNSHIP 7 NORTH, RANGE 3 WEST

ANCI52326

**LOCATION NOTICE FOR PLACER MINING CLAIM**

Amendment BLM Serial # \_\_\_\_\_

NOTICE IS HEREBY GIVEN that the Glow Wash 2  
\_\_\_\_\_ placer mining claim has been located by  
James Hamilton whose current mailing  
address is 34424 N. Tombstone St, San Tan Valley, AZ 85140

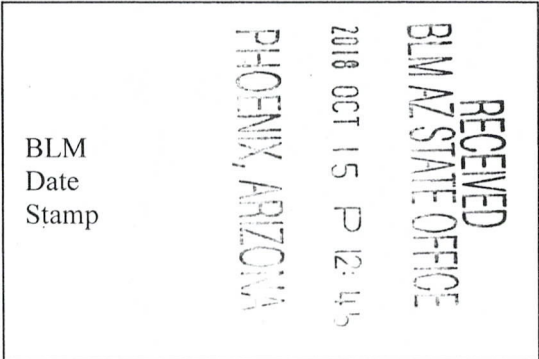

The general course of this claim is North to South and it is situated in Yavapai  
County, Arizona. This claim is 1320 feet in length and 660 feet in width.

20 Total Claim Acreage. This claim runs from the location monument on which this location notice is  
posted at the SE corner of the claim approximately 660 feet in a West direction to the  
West end line and 1320 feet in a North direction to the North end line. This claim is  
marked by four monuments, one at each corner of the claim.

The location monument on which this notice is posted is situated within Section 3, Township  
7 N, Range 3 W, Gila Salt River Base and Meridian, Arizona. This claim encompasses  
portions of the following legal subdivision(s) if located by legal subdivision or the following quarter section(s),  
section(s), Township(s) and Range(s) E 1/2 of NE 1/4 of Se 1/4 of Section 3, Township 7 North, Range 3 West  
\_\_\_\_\_, Gila Salt River Base and Meridian, Arizona.

The locality of this claim with reference to some natural object or permanent monument and additional information  
(if any) concerning its locality are as follows: \_\_\_\_\_  
\_\_\_\_\_

\_\_\_\_\_ The above information is shown on the attached map.

DATED AND POSTED on the ground this 11 day of October, 2018.

LOCATOR(s)  AGENT

Print Name(s) James Hamilton

Signature(s)

AMC452327



**MINING CLAIM MAP**

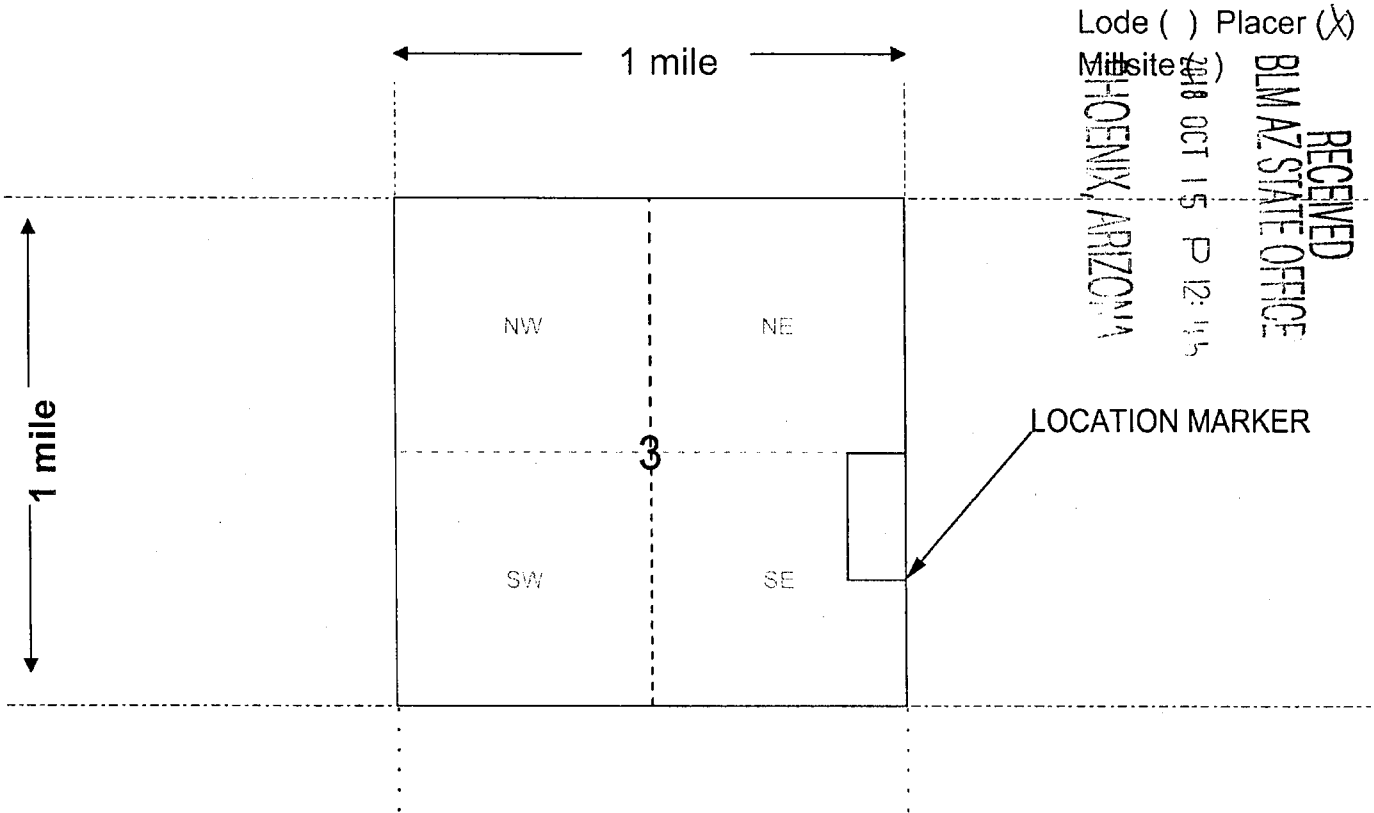

Scale: 1" = 2000 feet

1. The above map depicts the GLOW WASH 2 mining claim, which is located in Section (s) 3, Township 7 N, Range 3 W, Gila and Salt River Base and Meridian, YAVAPAI County, Arizona. Total claim acreage is 20

2. The type of corner and location monuments used are as follows: WHITE, CAPPED PVC PIPE

3. The bearings and distances in degrees and feet between claim corners and to a public land survey monument are as depicted on the map.

4. If the claim is a placer or millsite claim with exterior limits conforming to legal subdivisions of the public survey, provide a legal description of the claim \_\_\_\_\_

E 1/2 OF NE 1/4 OF SE 1/4 OF SECTION 3, TOWNSHIP 7 NORTH, RANGE 3 WEST

ARCH 5 23 27

RECEIVED  
BLM AZ STATE OFFICE  
2018 OCT 15 P 12:45  
PHOENIX, ARIZONA

**LOCATION NOTICE FOR PLACER MINING CLAIM**

Amendment BLM Serial # \_\_\_\_\_

NOTICE IS HEREBY GIVEN that the Iron Lock 3n  
\_\_\_\_\_ placer mining claim has been located by  
James Hamilton whose current mailing  
address is 34424 N. Tombstone St, San Tan Valley, AZ 85140

BLM  
Date  
Stamp

The general course of this claim is South and it is situated in Yavapai  
County, Arizona. This claim is 660 feet in length and 1320 feet in width.

20 Total Claim Acreage. This claim runs from the location monument on which this location notice is  
posted at the NE corner of the claim approximately 1320 feet in a West direction to the  
West end line and 660 feet in a South direction to the South end line. This claim is  
marked by four monuments, one at each corner of the claim.

The location monument on which this notice is posted is situated within Section 30, Township  
12.5 N, Range 2 W, Gila Salt River Base and Meridian, Arizona. This claim encompasses  
portions of the following legal subdivision(s) if located by legal subdivision or the following quarter section(s),  
section(s), Township(s) and Range(s) N1/2 of SE 1/4 of SW 1/4 of Section 30, Township 12.5N, Range 2W  
\_\_\_\_\_, Gila Salt River Base and Meridian, Arizona.

The locality of this claim with reference to some natural object or permanent monument and additional information  
(if any) concerning its locality are as follows: \_\_\_\_\_

\_\_\_\_\_ The above information is shown on the attached map.

DATED AND POSTED on the ground this 12 day of October, 2018.

LOCATOR(s)  AGENT

Print Name(s) James Hamilton

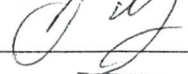
Signature(s) 

AMC452328

**MINING CLAIM MAP**

Lode ( ) Placer (X)  
Millsite ( )

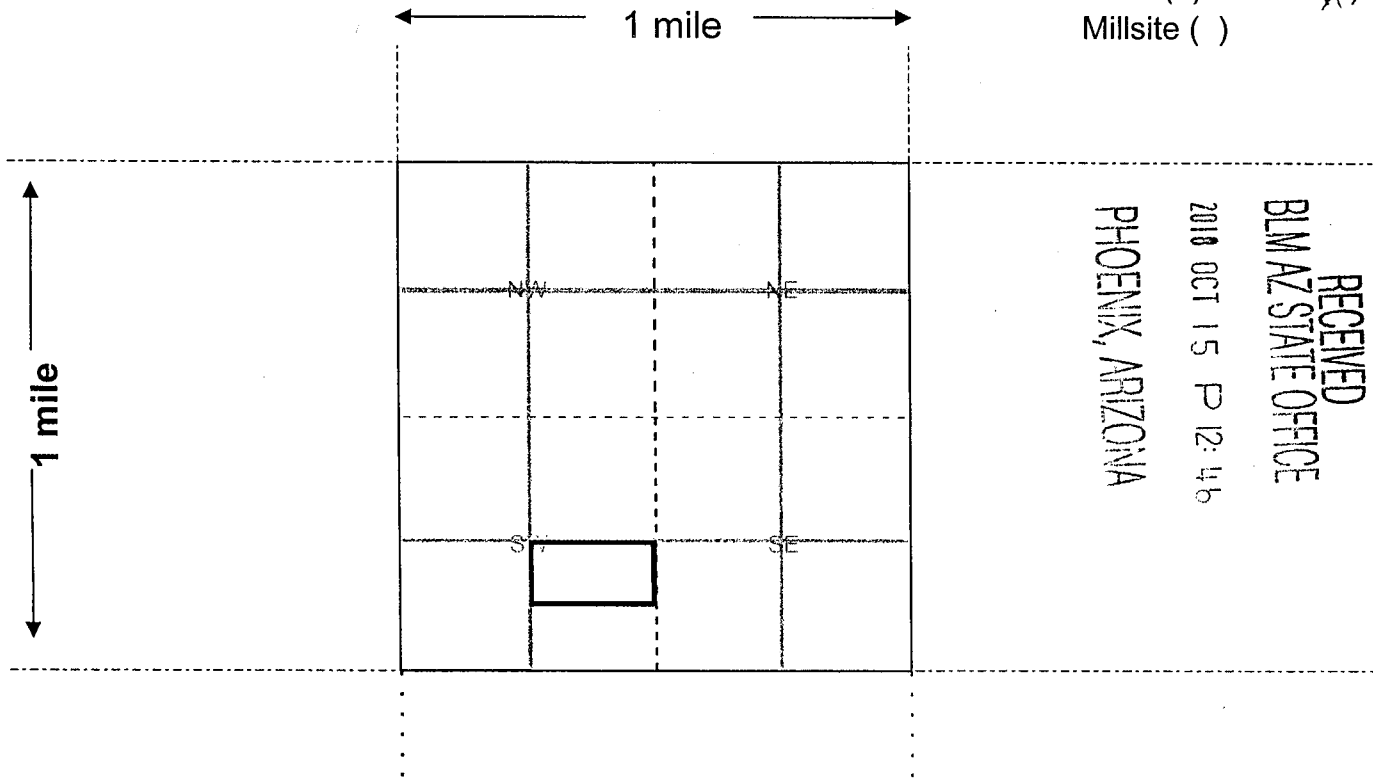

Scale: 1" = 2000 feet



1. The above map depicts the Iron Lock 3n mining claim, which is located in Section (s) 30, Township 12.5 N, Range 2 W, Gila and Salt River Base and Meridian, Yavapai County, Arizona. Total claim acreage is 20

2. The type of corner and location monuments used are as follows: White, capped pvc

3. The bearings and distances in degrees and feet between claim corners and to a public land survey monument are as depicted on the map.

4. If the claim is a placer or millsite claim with exterior limits conforming to legal subdivisions of the public survey, provide a legal description of the claim N1/2 of SE 1/4 of SW 1/4 of Section 30, Township 12.5N, Range 2W

Form MCF100a  
Revised July 2014

AMC452328

**LOCATION NOTICE FOR PLACER MINING CLAIM**

Amendment BLM Serial # \_\_\_\_\_

NOTICE IS HEREBY GIVEN that the Iron Lock 3s  
\_\_\_\_\_ placer mining claim has been located by  
James Hamilton whose current mailing  
address is 34424 N. Tombstone St, San Tan Valley, AZ 85140

RECEIVED  
BLM AZ STATE OFFICE  
2018 OCT 15 P 12:47  
PHOENIX, ARIZONA  
BLM  
Date  
Stamp

The general course of this claim is South and it is situated in Yavapai

County, Arizona. This claim is 660 feet in length and 1320 feet in width.

20 Total Claim Acreage. This claim runs from the location monument on which this location notice is posted at the NE corner of the claim approximately 1320 feet in a West direction to the West end line and 660 feet in a South direction to the South end line. This claim is marked by four monuments, one at each corner of the claim.

The location monument on which this notice is posted is situated within Section 30, Township

12.5 N, Range 2 W, Gila Salt River Base and Meridian, Arizona. This claim encompasses portions of the following legal subdivision(s) if located by legal subdivision or the following quarter section(s), section(s), Township(s) and Range(s) S1/2 of SE 1/4 of SW 1/4 of Section 30, Township 12.5N, Range 2W, Gila Salt River Base and Meridian, Arizona.

The locality of this claim with reference to some natural object or permanent monument and additional information (if any) concerning its locality are as follows: \_\_\_\_\_

\_\_\_\_\_ The above information is shown on the attached map.

DATED AND POSTED on the ground this 12 day of October, 2018.

LOCATOR(s)  AGENT

Print Name(s) James Hamilton

Signature(s) 

AMC452329



**MINING CLAIM MAP**

Lode ( ) Placer (X)  
 Millsite ( )

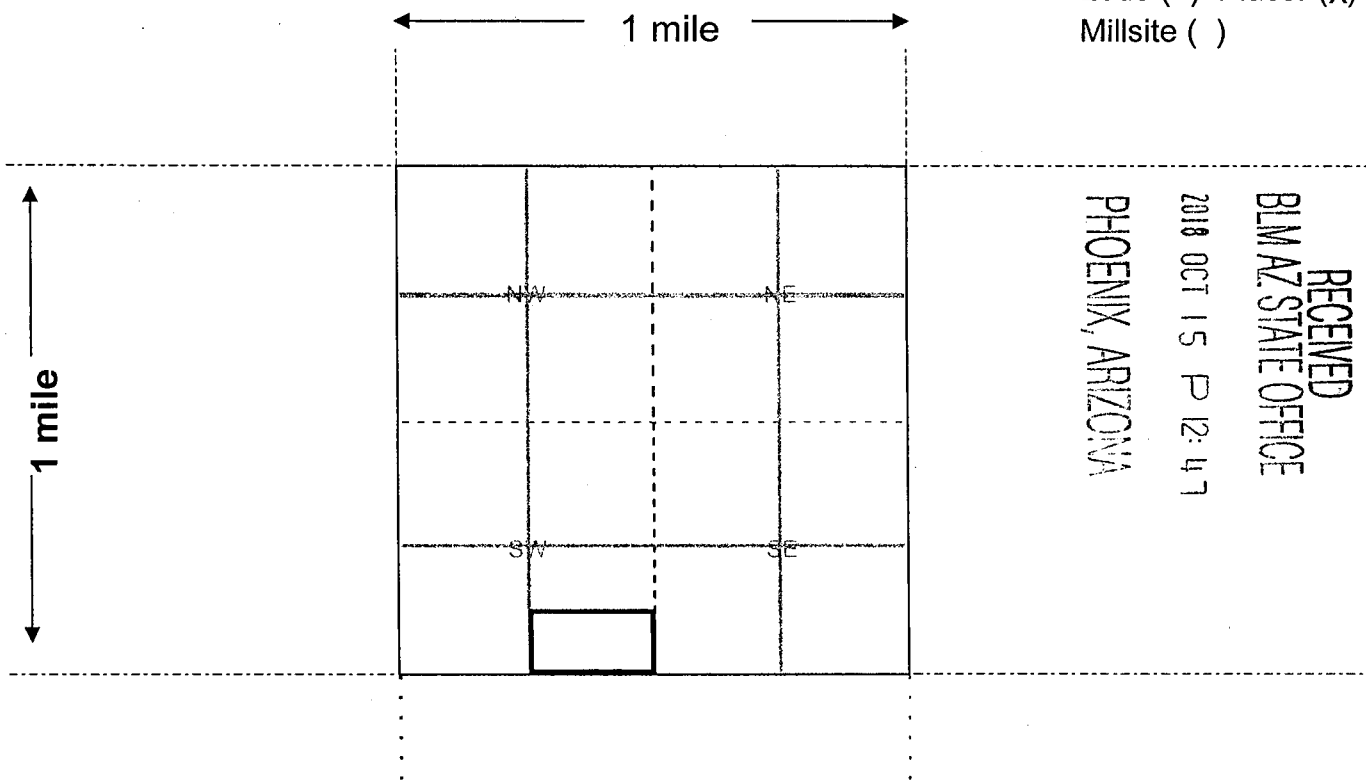

RECEIVED  
 BLM AZ STATE OFFICE  
 2010 OCT 15 P 12:47  
 PHOENIX, ARIZONA

Scale: 1" = 2000 feet



1. The above map depicts the Iron Lock 3S mining claim, which is located in Section (s) 30, Township 12.5 N, Range 2 W, Gila and Salt River Base and Meridian, Yavapai County, Arizona. Total claim acreage is 20

2. The type of corner and location monuments used are as follows: White, capped pvc

3. The bearings and distances in degrees and feet between claim corners and to a public land survey monument are as depicted on the map.

4. If the claim is a placer or millsite claim with exterior limits conforming to legal subdivisions of the public survey, provide a legal description of the claim S1/2 of SE 1/4 of SW 1/4 of Section 30, Township 12.5N, Range 2W

Form MCF100a  
 Revised July 2014

AMC452329

**LOCATION NOTICE FOR PLACER MINING CLAIM**

Amendment BLM Serial # \_\_\_\_\_

NOTICE IS HEREBY GIVEN that the Iron Lock 4  
\_\_\_\_\_ placer mining claim has been located by  
Tony Brown whose current mailing  
address is 33114 N. BRINLEE LANE, SAN TAN VALLEY, AZ 85143

RECEIVED BLM AZ STATE OFFICE 2018 OCT 15 P 12:47 PHOENIX, ARIZONA	BLM Date Stamp
--	----------------------

The general course of this claim is South and it is situated in Yavapai  
County, Arizona. This claim is 660 feet in length and 1320 feet in width.

20 Total Claim Acreage. This claim runs from the location monument on which this location notice is  
posted at the NE corner of the claim approximately 1320 feet in a West direction to the  
West end line and 660 feet in a South direction to the South end line. This claim is  
marked by four monuments, one at each corner of the claim.

The location monument on which this notice is posted is situated within Section 25, Township  
12.5 N, Range 3 W, Gila Salt River Base and Meridian, Arizona. This claim encompasses  
portions of the following legal subdivision(s) if located by legal subdivision or the following quarter section(s),  
section(s), Township(s) and Range(s) S1/2 of SE1/4 of SE 1/4 of Section 25, Township 12.5N, Range 3W  
\_\_\_\_\_, Gila Salt River Base and Meridian, Arizona.

The locality of this claim with reference to some natural object or permanent monument and additional information  
(if any) concerning its locality are as follows: \_\_\_\_\_

\_\_\_\_\_ The above information is shown on the attached map.

DATED AND POSTED on the ground this 12 day of October, 2018.

LOCATOR(s)  AGENT

Print Name(s) Tony Brown

Signature(s) Tony Brown

**Form MCF102**  
Revised July 2014

AMC452330



LR2K Home

CR-24



# LR2000 Internal

## CR Geographic Report with Land

[Download User Guide \(pdf\)](#)

Purpose: This report produces a geographic listing of case information based on retrieval by Meridian/Township/Range. This report format will display the case type, case disposition, meridian, township, range, section, survey type, survey number, surface management agency, pending actions, serial number, and total case acres.



### No Results

The specified criteria didn't result in any data. This is often caused by applying filters and/or selection steps that are too restrictive or that contain incorrect values. Please check your analysis filters and selection steps, and try again. The filters or selection steps currently being applied are shown below.

#### Filters

Disposition is equal to **AUTHORIZED, CANCELLED, EXPIRED, PENDING, REJECTED, RELINQUISHED, WITHDRAWN**  
and Meridian Township Range Section is equal to **14 0122N 0030W 025**  
and Admin State is equal to **AZ**

[Return](#) - Refresh



LR2K Home

CR-24



# LR2000 Internal

## CR Geographic Report with Land

[Download User Guide \(pdf\)](#)

Purpose: This report produces a geographic listing of case information based on retrieval by Meridian/Township/Range. This report format will display the case type, case disposition, meridian, township, range, section, survey type, survey number, surface management agency, pending actions, serial number, and total case acres.



### No Results

The specified criteria didn't result in any data. This is often caused by applying filters and/or selection steps that are too restrictive or that contain incorrect values. Please check your analysis filters and selection steps, and try again. The filters or selection steps currently being applied are shown below.

#### Filters

Disposition is equal to **AUTHORIZED, CANCELLED, EXPIRED, PENDING, REJECTED, RELINQUISHED, WITHDRAWN**  
and Meridian Township Range Section is equal to **14 0122N 0030W 036**  
and Admin State is equal to **AZ**

[Return](#) - Refresh

DEPARTMENT OF THE INTERIOR  
BUREAU OF LAND MANAGEMENT  
Case Recordation

**Geographic Report with Land**

Disposition is equal to **AUTHORIZED , CANCELLED , EXPIRED , PENDING , REJECTED , RELINQUISHED ,  
WITHDRAWN**  
**and** Meridian Township Range Section is equal to **14 0080N 0030W 034**  
**and** Admin State is equal to **AZ**

DEPARTMENT OF THE INTERIOR  
BUREAU OF LAND MANAGEMENT  
Case Recordation  
Geographic Report with Land

Admin State: AZ  
Geo State: AZ

Serial Number	Total Case Acres:	Casetype	Case Disp	Mer	Twp	Rng	Sec	Sur Type	Sur Nr	Suf	Subdivision	Act Pend
AZA 031568	1.000	293200	EXPIRED	14	0080N	0030W	034	FF			PORTION OF;	
AZA 035151	1.000	293200	PENDING					FF			PORTION OF;	

DEPARTMENT OF THE INTERIOR  
BUREAU OF LAND MANAGEMENT  
Case Recordation

**Geographic Report with Land**

Disposition is equal to **AUTHORIZED , EXPIRED , PENDING , REJECTED , RELINQUISHED ,  
WITHDRAWN**  
**and** Meridian Township Range Section is equal to **14 0070N 0030W 003**  
**and** Admin State is equal to **AZ**



DEPARTMENT OF THE INTERIOR  
BUREAU OF LAND MANAGEMENT  
Case Recordation  
Geographic Report with Land

Admin State: AZ  
Geo State: AZ

Serial Number	Total Case Acres:	Casetype	Case Disp	Mer	Twp	Rng	Sec	Sur Type	Sur Nr	Suf	Subdivision	Act Pend
AZA 031568	1.000	293200	EXPIRED	14	0070N	0030W	003	FF			PORTION OF;	
AZA 035151	1.000	293200	PENDING					FF			PORTION OF;	

DEPARTMENT OF THE INTERIOR  
BUREAU OF LAND MANAGEMENT  
Case Recordation

**Geographic Report with Land**

Disposition is equal to **AUTHORIZED , CANCELLED , EXPIRED , PENDING , REJECTED , RELINQUISHED ,  
WITHDRAWN**  
**and** Meridian Township Range Section is equal to **14 0122N 0020W 030**  
**and** Admin State is equal to **AZ**

DEPARTMENT OF THE INTERIOR  
BUREAU OF LAND MANAGEMENT  
Case Recordation  
Geographic Report with Land

Admin State: AZ  
Geo State: AZ

Serial Number	Total Case Acres:	Casetype	Case Disp	Mer	Twp	Rng	Sec	Sur Type	Sur Nr	Suf	Subdivision	Act Pend
AZA 024205PT	3,654.569	220200	AUTHORIZED	14	0122N	0020W	030	MS	2835	1		
AZA 030012PT	1,434.864	220200	AUTHORIZED					FF			PART OF MS 3876:	





















